



PLEASE READ CAREFULLY BEFORE USING

SWISSFLOAT™



Swissfloat has been a great success in equine dentistry market for almost 20 years. It is easy, fast and very gentle for horses. Swiss manufacturing guarantees highest quality with a one year limited warranty.

Swissfloat is a most practical instrument for visual and nonvisual dentistry. Regardless the approach, sedation and a full mouth speculum are highly recommended. The new slimline Swissfloat is the thinnest rotary float on the market. The last molars (such as the 311 and 411) are very easy to reach - even in smaller animals or miniature horses. The Slimfloat is very easy to handle and the procedure is gentle for horses. Swissfloat is conveniently available as a corded or cordless version and as a 16" or 21" version. A shorter 7" version for incisor work with no disk guards is available as well.

General information

Light weight corded Hitachi drill motor or cordless Dewalt motor with variable speed. The cordless motor has a thumbwheel (1) for pre-selection of maximum speed; which limits the maximum rpm of the motor



when locking the manual trigger. The reversing button (2) is disabled on purpose.



The corded model has to be used with GFCI (A) protection, which is designed to protect from electric shock.

Safety information

If you have long hair, ensure that it is properly tied back.

Wear protective gloves

Ensure suitable eye protection.

Use ear protection as excessive noise can cause damage to your hearing

Wear an appropriate respirator mask to protect you from potential airborne particles.

Make sure that you are familiar with the procedures and be aware of the potential hazards.

120V/220V Electrical apparatus should be used with GFCI protection only

Keep materials, tools and hands dry while using electrical apparatus.

Bulky clothing, rings, watches and dangling jewelry are dangerous when performing equine dentistry

Bleeding, heat, dust and noise

Bleeding is rarely a problem when using Swissfloat. It is most likely to occur if the gingiva caudal to the last molars (B) is injured. Grind this area carefully.

Prolonged grinding results in heat production which can potentially damage teeth. Check teeth with your hand and consider cooling teeth or the Swissfloat head with cold water as needed. Heat production is more likely to be a concern when using a dull or fine disk.



Dust and noise production should be taken seriously. It is only a minor issue for the dentist when using the nonvisual approach, where the instrument is not close to the operator's head. However, for visual dentistry a mask and ear plugs are recommended.



Safety information

Swissfloat is designed for equine use only.

Be always aware that accidents do happen when working with horses and do everything possible to avoid them.

Although easy to handle Swissfloat must be used by qualified and horse experienced persons only. Always inform your client of possible adverse effects of dental procedures.

Keep Swissfloat clean and dry after use. Lubrication is not required. Use water for cleaning very restrictively. Routine maintenance is recommended once a year.



Disk replacement (unplug machine before replacement)

A. Clean the two holes (2) on the disk with the pin of the changing plate (1) or a similar pointed instrument. Older disks do not have these holes (prior to 2002)

B. Block the disk with the changing metal plate (1) by pressing the two spikes into the two holes on the disk. Unscrew the central screw with a T25 Torx it screwdriver (comes with Swissfloat, 2).

C. Place new disk as shown in picture and tighten screw. Use a new screw with every new disk. **IMPORTANT:** Make sure the two small pins fit into the holes on the back side of the disk (1). Clean head (3) very carefully from excess dental debris before placement of new disk.

(The notch (2) was used in older models of the Swissfloat to block the disk with a pin. Do not try to remove any parts other than the disk.)

if you have difficulties locking the disk to unscrew the central screw, you may consider the use of pliers to carefully hold and lock the disk.

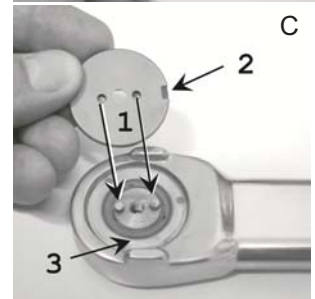
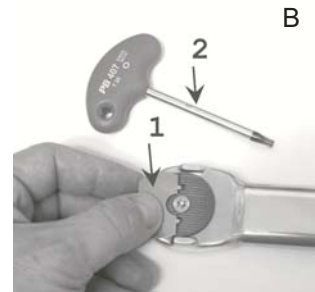
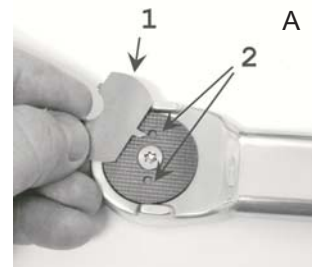

Rotate the shaft

The screw (1) on the gear box is holding the shaft in place. Keep this screw loose enough to easily rotate the shaft, and tight enough to ensure proper attachment of the shaft.

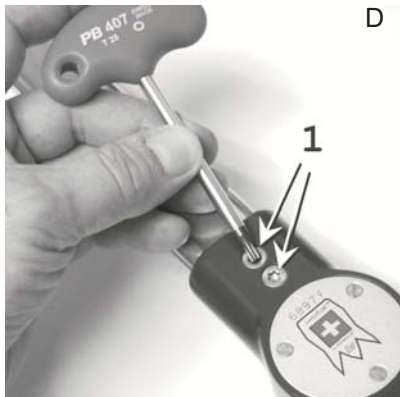

Belt Tension adjustment

The rotating disk is driven by a belt that is very similar to a fan belt in a car. The belt hardly ever breaks, but it may become loose with time. You will notice that the disk will easily stop and the float does not grind well.

You can readjust the tension easily by pushing the metal shaft and the green gear box apart. If tightening does not solve the problem, you should contact Swissvet.

D. Use a torx screwdriver T25 or key to loosen the two screws (1) on the base of the shaft. Do not remove screws completely.

E. Readjust tension (maximum 20 lbs) and tighten screws. You may place the shaft on a table, and lock the green gear box at the edge of the table (1) by pressing the gear box down. Apply the desired tension to the belt by pushing the shaft forward (2) with the other hand. Please don't try to repair the float yourself.

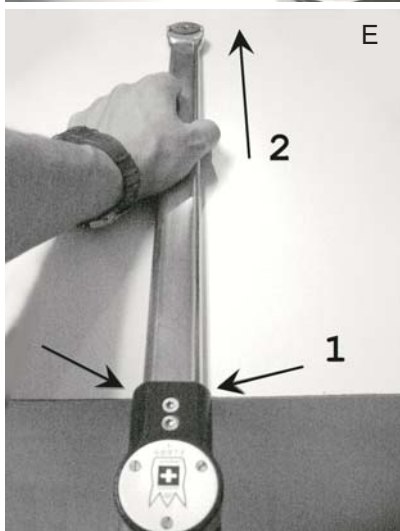

Clean the disk

The head part of the Swissfloat is water resistant but may not withstand excessive water during cleaning. Please use a wire brush to clean the disk and use water very restrictively.

Clean the disk immediately after each use - ground tooth material once dried - is very difficult to remove.



Keep the instrument clean and dry after use. There is no daily maintenance but yearly service by Swissvet is recommended.